

INSTALLATION INSTRUCTIONS

DESCRIPTION: Rear Brush Guard Kit
PART NUMBER: B4J-F85E0-V0
MODEL: 2021+ Wolverine RMax4



⚠ WARNING

Please read and understand these instructions completely before installation to avoid possible injury, or damage to the accessory or vehicle.

NOTICE:

This installation requires a torque wrench and should be performed by an authorized Yamaha dealer or other qualified technician.

WARRANTY INFORMATION:

In the United States, see your Yamaha dealer for a copy of the Yamaha Genuine Parts and Accessories Limited Warranty.

DEALER OR INSTALLER:

These instructions contain important information for future reference and *must* be given to the customer.

PARTS LIST:

No.	Part Number	Description	Qty
--	B4J-F85E0-V0	Rear Brush Guard Kit	--
①	*	Rear Brush Guard	1
②	*	Stud Plate	2
③	90111-08829	M8x18mm Button Head Bolt	2
④	*	Coined Washer	2
⑤	90179-10023	M10 Flange Nut	6
⑥	95812-10020	M10x20mm Flange Bolt	2
⑦	*	Left Lower Bracket	1
⑧	*	Right Lower Bracket	1

* Part supplied with kit only and not available separately.

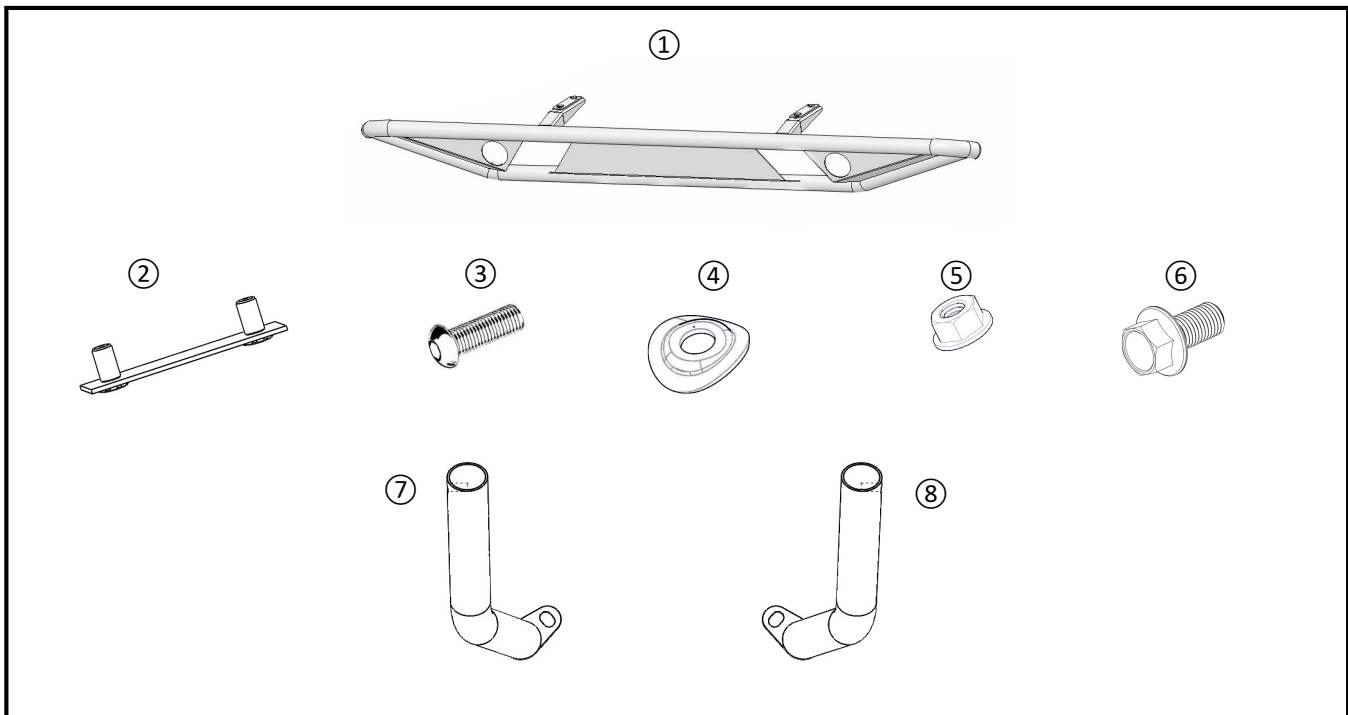

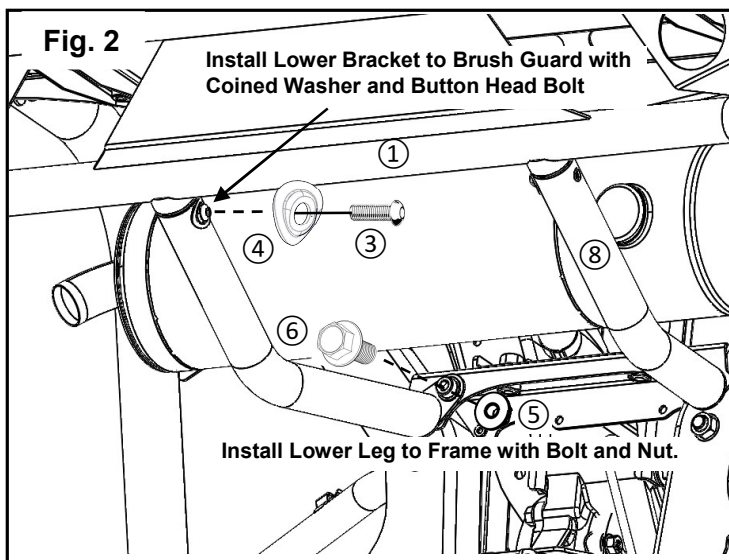
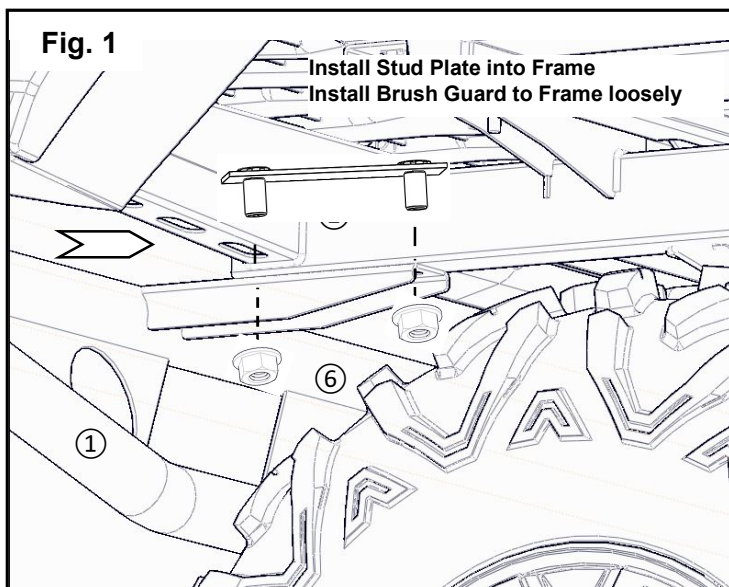

PREPARATION:

- Place the vehicle on a secure and level surface.
- Set the parking brake.
- Clean the mount surfaces before starting installation.

INSTALLATION:

No stock bolts are used.

1. Slide ② Stud Plates into frame (Fig.1)
2. Hold ① Rear Brush Guard up to frame and loosely thread 4 ⑥ M10x20mm Bolts to hold it.
3. Install ⑧ Right Lower Leg to ① Rear Brush Guard. Install boss on brush guard into open tube of lower leg (Fig. 2).
4. Thread 1 ⑥ M10x20mm Bolt through hole in ⑧ Right Lower Leg, through frame and into ⑤ M10 Flange Nut as shown in Fig. 2

Note: Ensure flange on ⑧ Right Lower Leg is flush to frame.

5. Repeat steps 3-4 on the left side.
6. Install ③ M8x18mm Button Head bolts through ④ Formed Washer and thread into threaded holes. (Fig. 2.)
7. Align the brush guard so that it is square and even from side to side and top to bottom.
8. Torque Specifications:
 - ⑥ M10x20mm bolts to 50-60 Nm (6.11 kg-m or 44.35 lb-ft maximum)
 - ③ M8x18mm Button Head Bolts to 25-30 Nm. (3.05 kg-m or 22.12 lb-ft maximum)

MAINTENANCE:

Periodically, check torque on all hardware. If loose hardware is found, re-torque to specification.

CARE AND CLEANING:

Clean painted metal parts with a clean soft cloth and mild soap and water. Rinse and dry.

CUSTOMER SERVICE:

For further information see your Yamaha dealer.

ESTIMATED TIME TO INSTALL: 0.6 HRS